

# 0.5 Module Spur Gear

## Plastic Spur Gear

### Overview

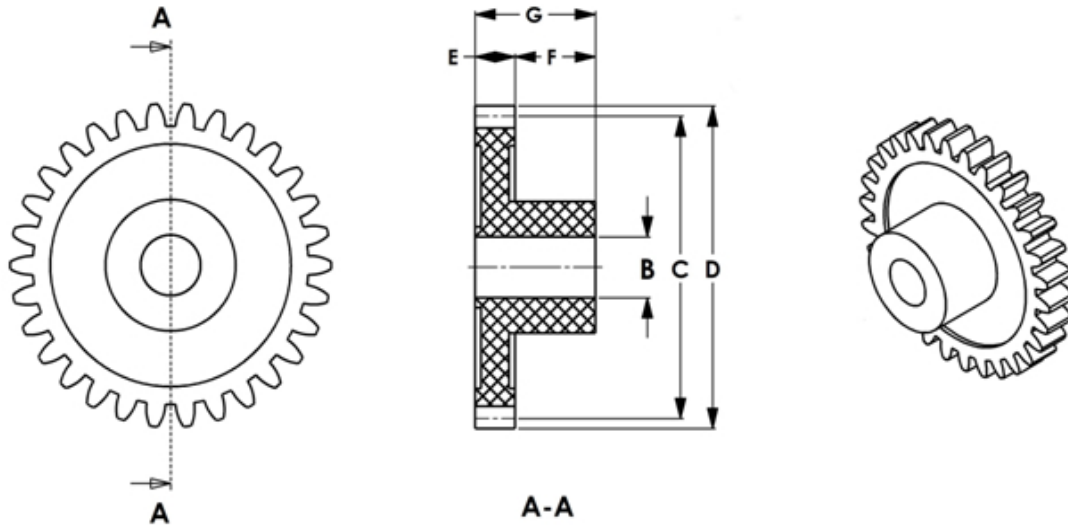

### SPECIFICATIONS

Teeth Range:  $20 \leq Z \leq 60$ , Pressure Angle:  $20^\circ$ , Bore Size: 1.9mm

Material: Acetal

Part no.	No of teeth	*Bore	Pitch dia.	Outside dia.	Face width	Hub width	Total length
	Z	B	C	D	E	F	G
GS0.5-20-19	20	1.9	10	11	2	4	6
GS0.5-22-19	22	1.9	11	12	2	4	6
GS0.5-24-19	24	1.9	12	13	2	4	6
GS0.5-25-19	25	1.9	12.5	13.5	2	4	6
GS0.5-26-19	26	1.9	13	14	2	4	6
GS0.5-28-19	28	1.9	14	15	2	4	6
GS0.5-30-19	30	1.9	15	16	2	4	6
GS0.5-32-19	32	1.9	16	17	2	4	6
GS0.5-34-19	34	1.9	17	18	2	4	6
GS0.5-35-19	35	1.9	17.5	18.5	2	4	6
GS0.5-36-19	36	1.9	18	19	2	4	6
GS0.5-38-19	38	1.9	19	20	2	4	6
GS0.5-40-19	40	1.9	20	21	2	4	6
GS0.5-42-19	42	1.9	21	22	2	4	6
GS0.5-44-19	44	1.9	22	23	2	4	6
GS0.5-45-19	45	1.9	22.5	23.5	2	4	6
GS0.5-46-19	46	1.9	23	24	2	4	6
GS0.5-48-19	48	1.9	24	25	2	4	6
GS0.5-50-19	50	1.9	25	26	2	4	6
GS0.5-52-19	52	1.9	26	27	2	4	6
GS0.5-54-19	54	1.9	27	28	2	4	6
GS0.5-55-19	55	1.9	27.5	28.5	2	4	6
GS0.5-56-19	56	1.9	28	29	2	4	6
GS0.5-58-19	58	1.9	29	30	2	4	6
GS0.5-60-19	60	1.9	30	31	2	4	6

Remarks:

\* The above bore size is for press-fit shaft  $\varnothing 2\text{mm}$ .

Unit: mm

# 0.5 Module Spur Gear

## Plastic Spur Gear

### Overview

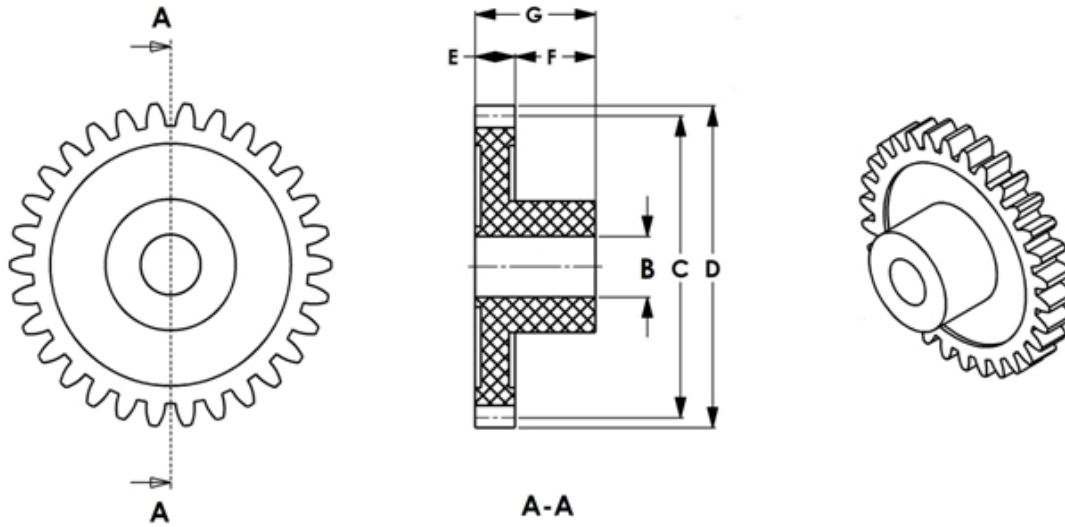

### SPECIFICATIONS

Teeth Range:  $20 \leq Z \leq 60$ , Pressure Angle:  $20^\circ$ , Bore Size: 2.9mm

Material: Acetal

Part no.	No of teeth	*Bore	Pitch dia.	Outside dia.	Face width	Hub width	Total length
	Z	B	C	D	E	F	G
GS0.5-20-29	20	2.9	10	11	2	4	6
GS0.5-22-29	22	2.9	11	12	2	4	6
GS0.5-24-29	24	2.9	12	13	2	4	6
GS0.5-25-29	25	2.9	12.5	13.5	2	4	6
GS0.5-26-29	26	2.9	13	14	2	4	6
GS0.5-28-29	28	2.9	14	15	2	4	6
GS0.5-30-29	30	2.9	15	16	2	4	6
GS0.5-32-29	32	2.9	16	17	2	4	6
GS0.5-34-29	34	2.9	17	18	2	4	6
GS0.5-35-29	35	2.9	17.5	18.5	2	4	6
GS0.5-36-29	36	2.9	18	19	2	4	6
GS0.5-38-29	38	2.9	19	20	2	4	6
GS0.5-40-29	40	2.9	20	21	2	4	6
GS0.5-42-29	42	2.9	21	22	2	4	6
GS0.5-44-29	44	2.9	22	23	2	4	6
GS0.5-45-29	45	2.9	22.5	23.5	2	4	6
GS0.5-46-29	46	2.9	23	24	2	4	6
GS0.5-48-29	48	2.9	24	25	2	4	6
GS0.5-50-29	50	2.9	25	26	2	4	6
GS0.5-52-29	52	2.9	26	27	2	4	6
GS0.5-54-29	54	2.9	27	28	2	4	6
GS0.5-55-29	55	2.9	27.5	28.5	2	4	6
GS0.5-56-29	56	2.9	28	29	2	4	6
GS0.5-58-29	58	2.9	29	30	2	4	6
GS0.5-60-29	60	2.9	30	31	2	4	6

Remarks: \* The above bore size is for press-fit shaft  $\varnothing 2\text{mm}$ .

Unit: mm